

**SUPPLEMENTAL BOUNDARY MAP
OF
COMMUNITY FACILITIES DISTRICT NO. 2005-1(H)
OF TEMECULA VALLEY UNIFIED SCHOOL DISTRICT
("CFD NO. 2005-1(H)")
RIVERSIDE COUNTY
STATE OF CALIFORNIA**

(MODIFYING THE BOUNDARY MAP FOR COMMUNITY FACILITIES DISTRICT NO. 2005-1 OF HEMET UNIFIED SCHOOL DISTRICT, RIVERSIDE COUNTY, STATE OF CALIFORNIA RECORDED ON MAY 28, 2005, IN BOOK 62 OF MAPS OF ASSESSMENT AND COMMUNITY FACILITIES DISTRICTS AT PAGE 82, AS INSTRUMENT NO. 2005-423072 IN THE OFFICE OF THE RECORDER FOR THE COUNTY OF RIVERSIDE, STATE OF CALIFORNIA.)

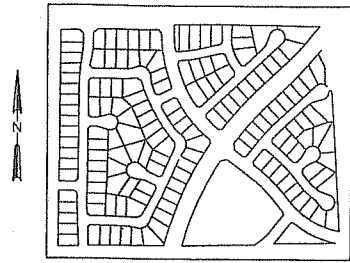

FILED IN THE OFFICE OF THE CLERK OF THE BOARD OF EDUCATION OF THE TEMECULA VALLEY UNIFIED SCHOOL DISTRICT THIS 15th DAY OF January, 20 16.

Sandra Hankson
CLERK OF THE BOARD OF EDUCATION
TEMECULA VALLEY UNIFIED SCHOOL DISTRICT
AS THE LEGISLATIVE BODY OF CFD NO. 2005-1(H)
STATE OF CALIFORNIA

I HEREBY CERTIFY THAT THIS SUPPLEMENTAL MAP OF THE BOUNDARIES OF CFD NO. 2005-1(H) IN THE COUNTY OF RIVERSIDE, STATE OF CALIFORNIA, AND RELATED TRANSFER OF GOVERNANCE, AUTHORIZED BY THE "GOVERNANCE TRANSFER AGREEMENT" UNDER SECTION 2(a) OF CHAPTER 206 OF THE 2013 LEGISLATION SESSION, OF CFD NO. 2005-1(H) FROM HEMET UNIFIED SCHOOL DISTRICT ("HUSD") TO THE TEMECULA VALLEY UNIFIED SCHOOL DISTRICT ("TVUSD") WAS APPROVED BY TVUSD ON THE 16TH DAY OF SEPTEMBER, 2014, BY ITS RESOLUTION NO. 2014-15/06 AND APPROVED BY THE HUSD ON THE 7TH DAY OF OCTOBER, 2014 BY ITS RESOLUTION NO. 2296. I FURTHER CERTIFY THAT BOTH THE "GOVERNANCE TRANSFER EFFECTIVE DATE" AND "REORGANIZATION EFFECTIVE DATE," IDENTIFIED IN THE GOVERNANCE TRANSFER AGREEMENT, OCCURRED ON JULY 1, 2015.

Sandra Hankson
CLERK OF THE BOARD OF EDUCATION
TEMECULA VALLEY UNIFIED SCHOOL DISTRICT
AS THE LEGISLATIVE BODY OF CFD NO. 2005-1(H)
STATE OF CALIFORNIA

FILED THIS 26th DAY OF JANUARY, 20 16, AT THE HOUR OF 12:05 O'CLOCK P.M. IN BOOK 79 OF MAPS OF ASSESSMENT AND COMMUNITY FACILITIES DISTRICTS AT PAGE(S) 23-24 AS INSTRUMENT NO. 2016-0028389 IN THE OFFICE OF THE RECORDER FOR THE COUNTY OF RIVERSIDE, STATE OF CALIFORNIA. FEE: \$ 12.00

Nancy Stearns S. Olson, DEPUTY
COUNTY RECORDER OF THE COUNTY OF RIVERSIDE

LOT DESIGNATION	ASSESSOR'S PARCEL NO
1	476320001
2	476320002
3	476320003
4	476320004
5	476320005
6	476321001
7	476321002
8	476321003
9	476321004
10	476321005
11	476321006
12	476321007
13	476321008
14	476321009
15	476321010
16	476321014
17	476321011
18	476321012
19	476321013
20	476322001
21	476322002
22	476322003
23	476322004
24	476322005
25	476322006
26	476322007
27	476322008
28	476322009
29	476322010
30	476322011
31	476322012
32	476322013
33	476322014
34	476322015
35	476322016
36	476322017
37	476322018
38	476322019
39	476323001
40	476323002
41	476323003
42	476323004
43	476323005
44	476323006
45	476323007
46	476323008
47	476323009
48	476323010
49	476323011
50	476323012
51	476323013

LOT DESIGNATION	ASSESSOR'S PARCEL NO
52	476323014
53	476323015
54	476323016
55	476323017
56	476323018
57	476323019
58	476323020
59	476323021
60	476323022
61	476323023
62	476323024
63	476323025
64	476323026
65	476323027
66	476323028
67	476323029
68	476323030
69	476323031
70	476323032
71	476323033
72	476323034
73	476323035
74	476323036
75	476323037
76	476330001
77	476330002
78	476330003
79	476330004
80	476330005
81	476330006
82	476330007
83	476330008
84	476330009
85	476330010
86	476330011
87	476330012
88	476330013
89	476330014
90	476331001
91	476331002
92	476331003
93	476331004
94	476331005
95	476331006
96	476331007
97	476331008
98	476332005
99	476332001
100	476332002
101	476332003
102	476332004

LOT DESIGNATION	ASSESSOR'S PARCEL NO
103	476333001
104	476333002
105	476333003
106	476333004
107	476333005
108	476333006
109	476333007
110	476333008
111	476333009
112	476333010
113	476333011
114	476333012
115	476333013
116	476333014
117	476333015
118	476340001
119	476340002
120	476340003
121	476340004
122	476340005
123	476340006
124	476340007
125	476340008
126	476340009
127	476340010
128	476340011
129	476340012
130	476340013
131	476340014
132	476340015
133	476340016
134	476340017
135	476340018
136	476340019
137	476340020
138	476340021
139	476340022
140	476340023
141	476340024
142	476340025
143	476340026
144	476340027
145	476340028
146	476340029
147	476340030
148	476340031
149	476340032
150	476340033
151	476340034
152	476340035
153	476340037

S DFA
SPECIAL DISTRICT FINANCING
& ADMINISTRATION

437 WEST GRAND AVENUE
ESCONDIDO, CALIFORNIA 92025
TELEPHONE: (760)233-2630
FAX: (760)233-2631

PROPOSED BOUNDARY MAP OF
COMMUNITY FACILITIES DISTRICT NO. 2005-1
OF HEMET UNIFIED SCHOOL DISTRICT
RIVERSIDE COUNTY
STATE OF CALIFORNIA

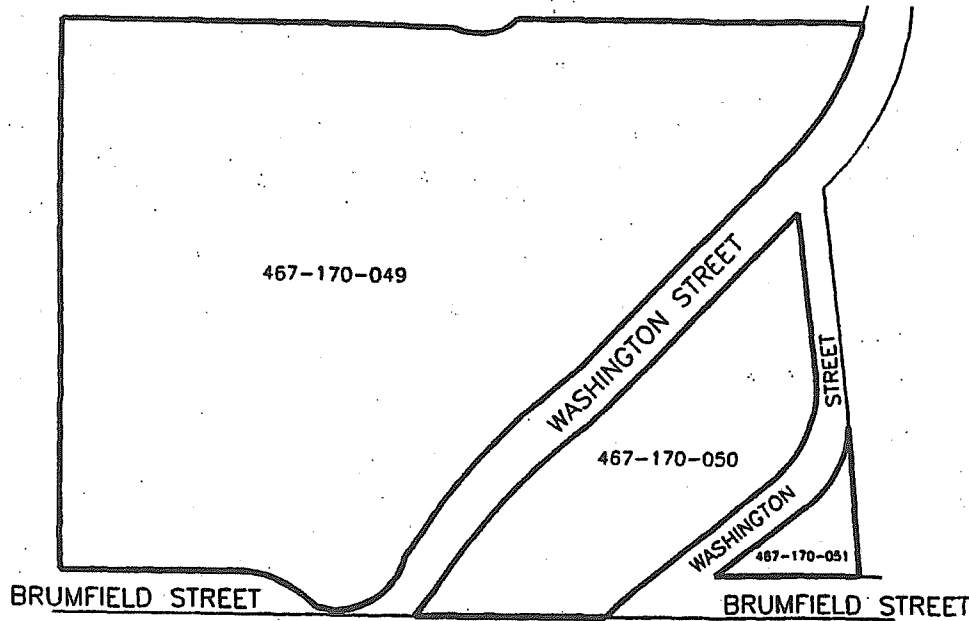

(1) Filed in the office of the Secretary of the Governing Board this ___ day of _____, 20__.

Philip O. Pendley
Secretary of the Governing Board

(2) I hereby certify that the within map showing the boundaries of Community Facilities District No. 2005-1 of the Hemet Unified School District, Riverside County, State of California, was approved by the Governing Board at a regular meeting thereof, held on this ___ day of _____, 20__ by its Resolution No. _____.

Philip O. Pendley
Secretary of the Governing Board

(3) Filed this ___ day of _____, 20__ of the hour ___ o'clock ___ m. in Book ___ of Maps of Assessment and Community Facilities Districts of page ___ and as Instrument No. ___ in the office of the County Recorder of Riverside County, State of California.

County Recorder of Riverside County

Reference is hereby made to the Assessor maps of the County of Riverside for an exact description of the lines and dimensions of each lot and parcel.

LEGEND

	Boundaries of Community Facilities District No. 2005-1
	Assessor Parcel Boundary
	Riverside County Assessor Parcel Number

PREPARED BY
DAVID TAUSSIG & ASSOCIATES, INC.

Recorded May 26, 2005 Book 62 Page 82
Instrument No. 2005-423072