

**PROPOSED BOUNDARY MAP OF
TEMECULA VALLEY UNIFIED SCHOOL DISTRICT
COMMUNITY FACILITIES DISTRICT NO. 2010-1**

COUNTY OF RIVERSIDE
STATE OF CALIFORNIA

LOT DESIGNATION	TAX ZONE	LOT NO.	TRACT	ASSESSOR'S PARCEL NUMBER
1	1	11	29114	480-550-004
2	1	12	29114	480-550-005
3	1	13	29114	480-550-006
4	1	14	29114	480-550-007
5	1	15	29114	480-550-008
6	1	16	29114	480-550-009
7	1	17	29114	480-550-010
8	1	18	29114	480-550-011
9	1	19	29114	480-550-012
10	1	20	29114	480-550-013
11	1	21	29114	480-550-014
12	1	22	29114	480-550-015
13	1	23	29114	480-550-016
14	1	24	29114	480-550-017
15	1	25	29114	480-550-018
16	1	26	29114	480-550-019
17	1	27	29114	480-550-020
18	1	28	29114	480-550-021
19	1	29	29114	480-550-022
20	1	30	29114	480-550-023
21	1	31	29114	480-550-024
22	1	32	29114	480-550-025
23	1	33	29114	480-550-026
24	1	34	29114	480-550-027
25	1	35	29114	480-550-028
26	1	36	29114	480-550-029
27	1	37	29114	480-550-030
28	1	38	29114	480-550-031
29	1	39	29114	480-550-032
30	1	40	29114	480-550-033
31	1	41	29114	480-550-034
32	1	42	29114	480-550-035
33	1	43	29114	480-550-036
34	1	44	29114	480-550-037
35	1	45	29114	480-550-038
36	1	46	29114	480-550-039
37	1	47	29114	480-551-001
38	1	48	29114	480-551-002
39	1	49	29114	480-551-003
40	1	50	29114	480-551-004
41	1	51	29114	480-551-005
42	1	52	29114	480-551-006
43	1	53	29114	480-551-007
44	1	54	29114	480-551-008
45	1	55	29114	480-551-009
46	1	56	29114	480-551-010
47	1	57	29114	480-551-011
48	1	58	29114	480-551-012
49	1	59	29114	480-551-013
50	1	60	29114	480-260-012

LOT DESIGNATION	TAX ZONE	LOT NO.	TRACT	ASSESSOR'S PARCEL NUMBER
51	1	61	29114	480-260-013
52	1	62	29114	480-260-014
53	1	63	29114	480-260-015
54	1	64	29114	480-260-016
55	1	13	29114-1	480-281-012
56	1	14	29114-1	480-281-013
57	1	20	29114-1	480-281-019
58	1	21	29114-1	480-281-020
59	1	22	29114-1	480-281-021
60	1	23	29114-1	480-281-022
61	2	1	CP*	480-621-001
62	2	2	CP*	480-621-002
63	2	3	CP*	480-621-003
64	2	4	CP*	480-621-004
65	2	5	CP*	480-621-005
66	2	6	CP*	480-621-006
67	2	7	CP*	480-621-007
68	2	8	CP*	480-621-008
69	2	9	CP*	480-621-009
70	2	10	CP*	480-621-010
71	2	11	CP*	480-621-011
72	2	12	CP*	480-621-012
73	2	13	CP*	480-621-013
74	2	14	CP*	480-621-014
75	2	15	CP*	480-621-015
76	2	16	CP*	480-621-016
77	2	17	CP*	480-621-017
78	2	18	CP*	480-621-018
79	2	19	CP*	480-621-019
80	2	20	CP*	480-621-020
81	2	21	CP*	480-621-021
82	2	22	CP*	480-621-022
83	2	23	CP*	480-621-023
84	2	24	CP*	480-621-024
85	2	25	CP*	480-621-025
86	2	26	CP*	480-621-026
87	2	27	CP*	480-621-027
88	2	28	CP*	480-621-028
89	2	29	CP*	480-621-029
90	2	30	CP*	480-621-030
91	2	31	CP*	480-621-031
92	2	32	CP*	480-621-032
93	2	33	CP*	480-621-033
94	2	34	CP*	480-621-034
95	2	35	CP*	480-621-035
96	2	36	CP*	480-621-036
97	2	37	CP*	480-621-037
98	2	38	CP*	480-621-038
99	2	39	CP*	480-621-039
100	2	40	CP*	480-621-040

LOT DESIGNATION	TAX ZONE	LOT NO.	TRACT	ASSESSOR'S PARCEL NUMBER
101	2	41	CP*	480-621-041
102	2	42	CP*	480-621-042
103	2	43	CP*	480-621-043
104	2	44	CP*	480-621-044
105	2	45	CP*	480-621-045
106	2	46	CP*	480-621-046
107	2	47	CP*	480-621-047
108	2	48	CP*	480-621-048
109	2	49	CP*	480-621-049
110	2	50	CP*	480-621-050
111	2	51	CP*	480-621-051
112	2	52	CP*	480-621-052
113	2	53	CP*	480-621-053
114	2	54	CP*	480-621-054
115	2	55	CP*	480-621-055
116	2	56	CP*	480-621-056
117	2	57	CP*	480-621-057
118	2	58	CP*	480-621-058
119	2	59	CP*	480-621-059
120	2	60	CP*	480-621-060
121	2	61	CP*	480-621-061
122	2	62	CP*	480-621-062
123	2	63	CP*	480-621-063
124	2	64	CP*	480-621-064
125	2	65	CP*	480-621-065
126	2	66	CP*	480-621-066
127	2	67	CP*	480-621-067
128	2	68	CP*	480-621-068
129	2	69	CP*	480-621-069
130	2	70	CP*	480-621-070
131	2	71	CP*	480-621-071
132	2	72	CP*	480-621-072
133	2	73	CP*	480-621-073
134	2	74	CP*	480-621-074
135	2	75	CP*	480-621-075
136	2	76	CP*	480-621-076
137	2	77	CP*	480-621-077
138	2	78	CP*	480-621-078
139	2	79	CP*	480-621-079
140	2	80	CP*	480-621-080
141	2	81	CP*	480-621-081
142	2	82	CP*	480-621-082
143	2	83	CP*	480-621-083
144	2	84	CP*	480-621-084
145	2	85	CP*	480-621-085
146	2	86	CP*	480-621-086
147	2	87	CP*	480-621-087
148	2	88	CP*	480-621-088
149	2	89	CP*	480-621-089
150	2	90	CP*	480-621-090

LOT DESIGNATION	TAX ZONE	LOT NO.	TRACT	ASSESSOR'S PARCEL NUMBER
151	2	91	CP*	480-621-091
152	2	92	CP*	480-621-092
153	2	93	CP*	480-621-093
154	2	94	CP*	480-621-094
155	2	95	CP*	480-621-095
156	2	96	CP*	480-621-096
157	2	97	CP*	480-621-097
158	2	98	CP*	480-621-098
159	2	99	CP*	480-621-099
160	2	100	CP*	480-621-100
161	2	101	CP*	480-621-101
162	2	102	CP*	480-621-102
163	2	103	CP*	480-621-103
164	2	104	CP*	480-621-104
165	2	105	CP*	480-621-105
166	2	106	CP*	480-621-106
167	2	107	CP*	480-621-107
168	2	108	CP*	480-621-108
169	2	109	CP*	480-621-109
170	2	110	CP*	480-621-110
171	2	111	CP*	480-621-111
172	2	112	CP*	480-621-112
173	2	113	CP*	480-621-113
174	2	114	CP*	480-621-114
175	2	115	CP*	480-621-115
176	2	116	CP*	480-621-116
177	2	117	CP*	480-621-117
178	2	118	CP*	480-621-118
179	2	119	CP*	480-621-119
180	2	120	CP*	480-621-120
181	2	121	CP*	480-621-121
182	2	122	CP*	480-621-122
183	2	123	CP*	480-621-123
184	2	124	CP*	480-621-124
185	2	125	CP*	480-621-125
186	2	126	CP*	480-621-126
187	2	127	CP*	480-621-127
188	2	128	CP*	480-621-128
189	2	129	CP*	480-621-129
190	2	130	CP*	480-621-130
191	2	131	CP*	480-621-131
192	2	132	CP*	480-621-132
193	2	133	CP*	480-621-133
194	2	134	CP*	480-621-134
195	2	135	CP*	480-621-135
196	2	136	CP*	480-621-136
197	2	137	CP*	480-621-137
198	2	138	CP*	480-621-138
199	2	139	CP*	480-621-139
200	2	140	CP*	480-621-140
201	2	141	CP*	480-621-141
202	2	142	CP*	480-621-142
203	2	143	CP*	480-621-143
204	2	144	CP*	480-621-144
205	2	145	CP*	480-621-145
206	2	146	CP*	480-621-146
207	2	147	CP*	480-621-147

FILED IN THE OFFICE OF THE SECRETARY OF THE BOARD OF EDUCATION OF THE TEMECULA VALLEY UNIFIED SCHOOL DISTRICT THIS 1st DAY OF December 2010.

Timothy Ritter
TIMOTHY RITTER
SECRETARY OF THE BOARD OF EDUCATION
TEMECULA VALLEY UNIFIED SCHOOL DISTRICT
STATE OF CALIFORNIA

I HEREBY CERTIFY THAT THE WITHIN MAP SHOWING THE PROPOSED BOUNDARIES OF COMMUNITY FACILITIES DISTRICT NO. 2010-1, RIVERSIDE COUNTY, STATE OF CALIFORNIA, WAS APPROVED BY THE BOARD OF EDUCATION OF THE TEMECULA VALLEY UNIFIED SCHOOL DISTRICT AT A REGULAR MEETING THEREOF HELD ON THE 14th DAY OF December 2010, BY ITS RESOLUTION NO. 2010-11/18.

Timothy Ritter
TIMOTHY RITTER
SECRETARY OF THE BOARD OF EDUCATION
TEMECULA VALLEY UNIFIED SCHOOL DISTRICT
STATE OF CALIFORNIA

FILED THIS 17th DAY OF December 2010 AT THE HOUR OF 4:46 O'CLOCK P.M. IN BOOK 19 OF MAPS OF Page 100-102 ASSESSMENT AND COMMUNITY FACILITIES DISTRICTS AND AS INSTRUMENT NO. 2010-0607927 IN THE OFFICE OF THE COUNTY RECORDER OF RIVERSIDE COUNTY, STATE OF CALIFORNIA
Fee: \$4.00

Debbie Gomez
Debbie Gomez
Deputy
LAND RECORDS
COUNTY RECORDER OF RIVERSIDE COUNTY

NOTE: FOR PARTICULARS OF LINES AND DIMENSIONS OF ASSESSOR'S PARCELS, REFERENCE IS MADE TO THE RIVERSIDE COUNTY ASSESSOR'S PARCEL MAPS.

ZIMMERMAN GROUP
LAND DEVELOPMENT SOLUTIONS
28022 CABOT ROAD, SUITE 620
LAGUNA HILLS, CA 92657
(949) 542-7070 PHONE (949) 542-7070 FAX
WWW.ZIMMERMANGROUP.COM

City 74
101

SHEET 2 OF 3
11/29/2010

PROPOSED BOUNDARY MAP OF TEMECULA VALLEY UNIFIED SCHOOL DISTRICT COMMUNITY FACILITIES DISTRICT NO. 2010-1

COUNTY OF RIVERSIDE
STATE OF CALIFORNIA

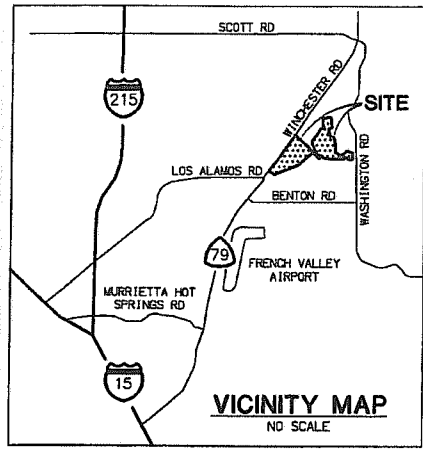

LEGEND
 (1) LOT DESIGNATION
 — CFD BOUNDARY

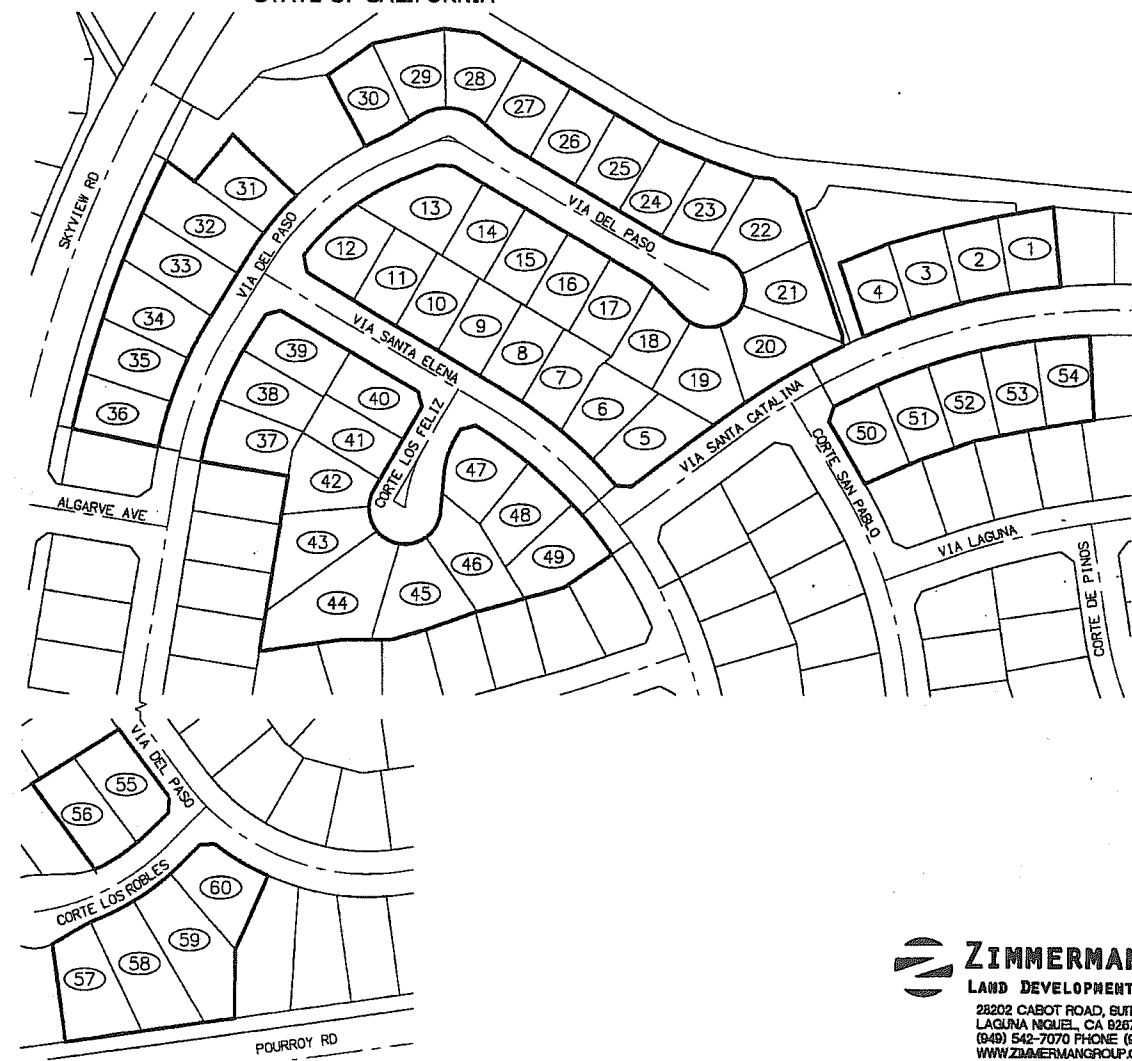

ZIMMERMAN GROUP
 LAND DEVELOPMENT SOLUTIONS
 28202 CABOT ROAD, SUITE 620
 LAGUNA NIGUEL, CA 92677
 (949) 542-7070 PHONE (949) 542-7076 FAX
 WWW.ZIMMERMANGROUP.COM

City
74
102
SHEET 3 OF 3
11/29/2010

PROPOSED BOUNDARY MAP OF
TEMECULA VALLEY UNIFIED SCHOOL DISTRICT
COMMUNITY FACILITIES DISTRICT NO. 2010-1
COUNTY OF RIVERSIDE
STATE OF CALIFORNIA

WINCHESTER RD / STATE HWY 79

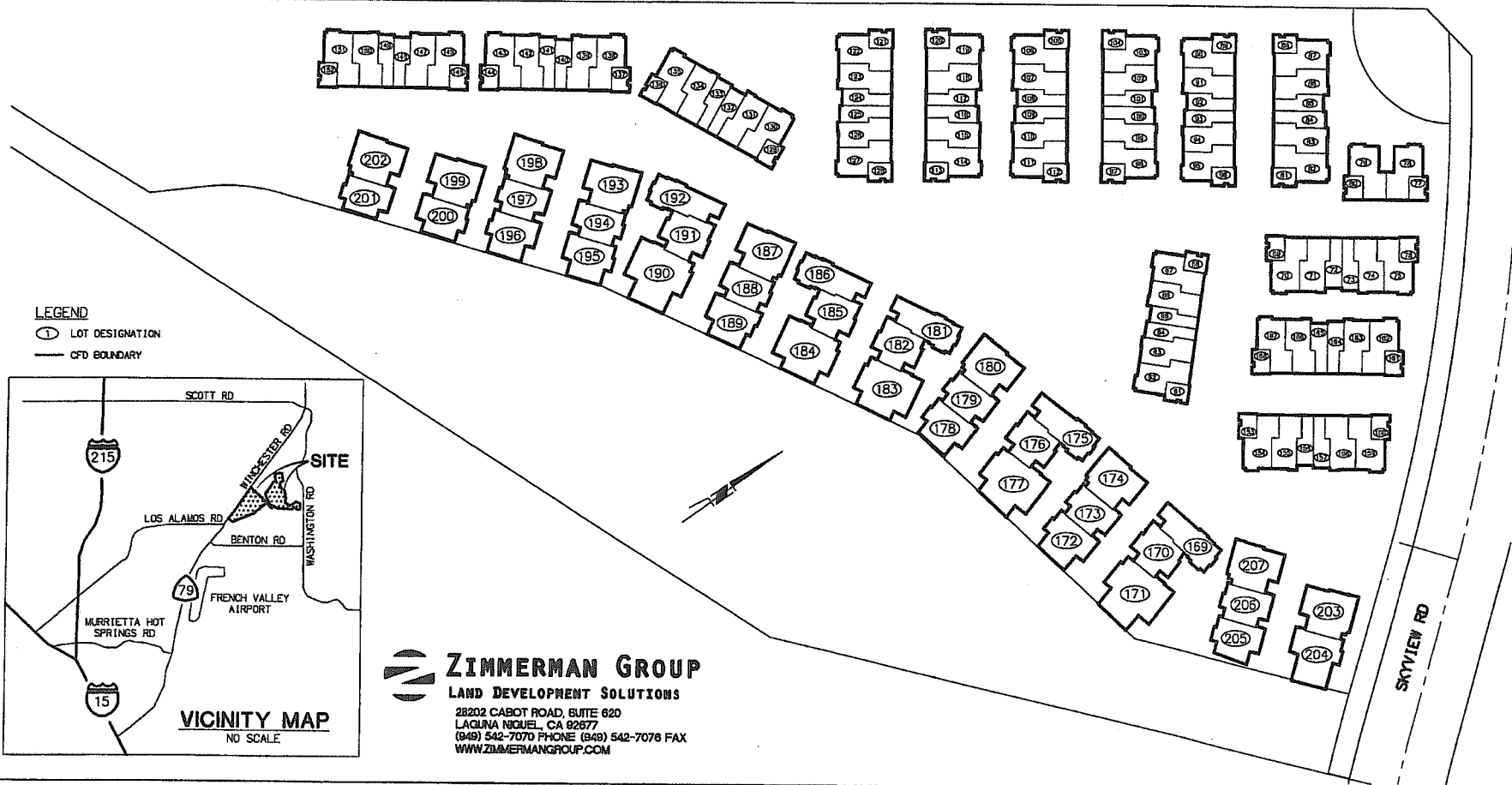

LEGEND
○ LOT DESIGNATION
— CFD BOUNDARY

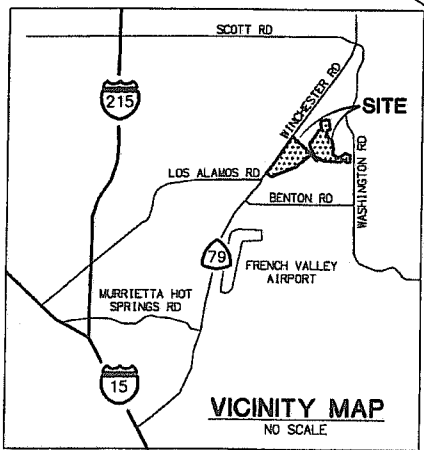

ZIMMERMAN GROUP
LAND DEVELOPMENT SOLUTIONS
28202 CABOT ROAD, SUITE 620
LAGUNA HILLS, CA 92653
(949) 542-7070 PHONE (949) 542-7076 FAX
WWW.ZIMMERMANGROUP.COM