

PROPOSED BOUNDARY MAP OF
TEMECULA VALLEY UNIFIED SCHOOL DISTRICT
COMMUNITY FACILITIES DISTRICT NO. 2018-1

COUNTY OF RIVERSIDE
STATE OF CALIFORNIA

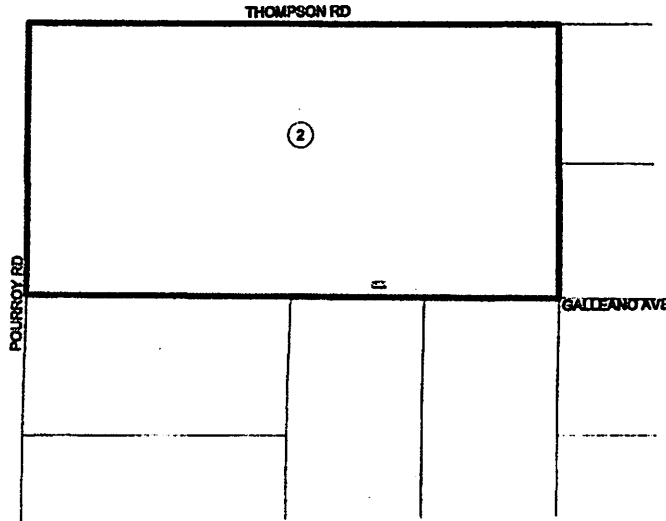
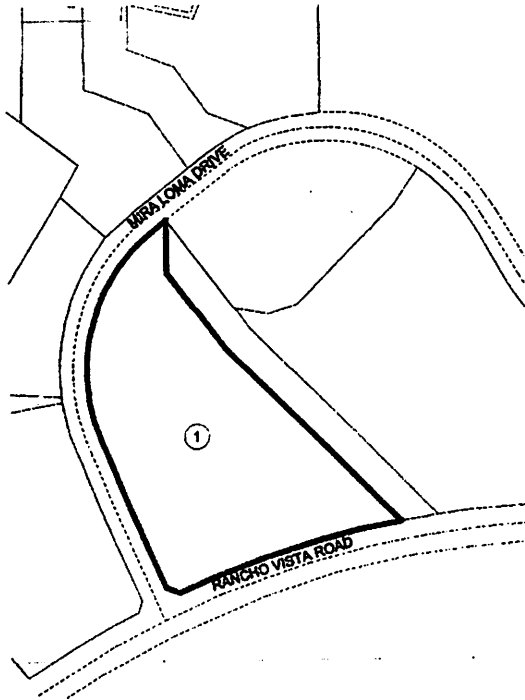

FILED IN THE OFFICE OF THE CLERK OF THE BOARD OF
EDUCATION OF THE TEMECULA VALLEY UNIFIED SCHOOL
DISTRICT THIS 3rd DAY OF JANUARY, 2018.

John Hill
CLERK OF THE BOARD OF EDUCATION
TEMECULA VALLEY UNIFIED SCHOOL DISTRICT
STATE OF CALIFORNIA

I HEREBY CERTIFY THAT THE WITHIN MAP SHOWING THE
BOUNDARIES OF COMMUNITY FACILITIES DISTRICT NO. 2018-1,
RIVERSIDE COUNTY, STATE OF CALIFORNIA, WAS APPROVED
BY THE BOARD OF EDUCATION OF THE TEMECULA VALLEY
UNIFIED SCHOOL DISTRICT AT A REGULAR MEETING THEREOF,
HELD ON THE 14th DAY OF JANUARY, 2018, BY ITS
RESOLUTION NO. 2017-18/20.

John Hill
CLERK OF THE BOARD OF EDUCATION
TEMECULA VALLEY UNIFIED SCHOOL DISTRICT
STATE OF CALIFORNIA

FILED THIS 22nd DAY OF JANUARY, 2018, AT
THE HOUR OF 10:50 O'CLOCK A.M. IN BOOK
81 OF MAPS OF ASSESSMENT AND COMMUNITY
FACILITIES DISTRICTS AT PAGES 77 AND AS
INSTRUMENT NO. 2018-0028191, IN THE OFFICES OF
THE COUNTY RECORDER OF RIVERSIDE COUNTY, STATE OF
CALIFORNIA.
FEE: \$ 84.-

BY: *Marina Shores S. Olvera* COUNTY RECORDER
COUNTY RECORDER OF THE COUNTY OF RIVERSIDE
PETER ALDANA

LEGEND:

①

LOT NUMBER

—————

COMMUNITY FACILITIES
DISTRICT BOUNDARY

LOT DESIGNATION			
LOT NO.	ASSESSOR'S PARCEL NO.	TRACT NO.	LOCATION
1	944-269-003	31584	CITY OF TEMECULA
2	944-616-001	35181	COUNTY OF RIVERSIDE



SDFA
SPECIAL DISTRICT FINANCING
& ADMINISTRATION

437 WEST GRAND AVENUE
ESCONDIDO, CALIFORNIA 92025
TELEPHONE: (760)233-2630
FAX: (760)233-2631

NOTE: FOR PARTICULARS OF LINES AND
DIMENSIONS OF ASSESSOR'S PARCELS,
REFERENCE IS MADE TO THE RIVERSIDE
COUNTY ASSESSOR'S PARCEL MAPS.

SHEET	1 OF 1
DATE	JANUARY 2018
JOB NO.	CFD 2018-1